

20 School House Village
Bakari Brinson
50-21

22 School House Village
Oak Bluffs Assessor's Parcel (50-22)
18,770 ± sq.ft.

Village Road
Island Elderly Housing
50-87

School House Village

24 School House Village
Glenn Brewington
50-23

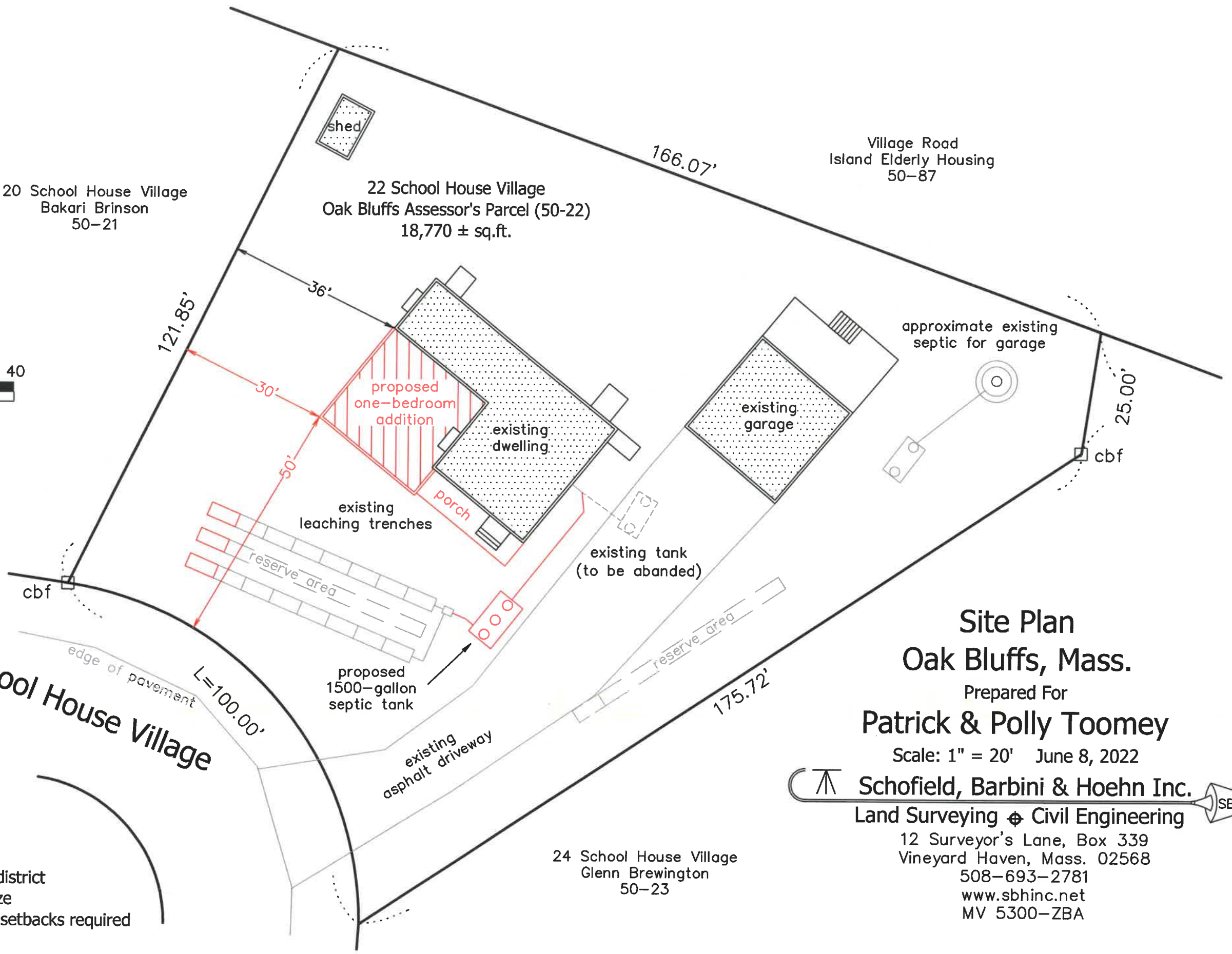

approximate existing
septic for garage

proposed
one-bedroom
addition

existing
dwelling

existing
garage

existing
leaching
trenches

porch

existing tank
(to be abanded)

proposed
1500-gallon
septic tank

existing
asphalt
driveway

Site Plan Oak Bluffs, Mass.

Prepared For
Patrick & Polly Toomey

Scale: 1" = 20' June 8, 2022

Schofield, Barbini & Hoehn Inc.
Land Surveying & Civil Engineering

12 Surveyor's Lane, Box 339
Vineyard Haven, Mass. 02568
508-693-2781
www.sbhinc.net
MV 5300-ZBA



Note:
Locus lies in the R-3 zoning district
60,000 sq.ft. minimum lot size
50' front, side and rear yard setbacks required

